



TOPCON - TYPE M10

BAUER SOLARTECHNIK

SUPERBLACK

BS-144M10NHBB-GG 575 - 585 W

BIFACIAL GLASS-GLASS HALF-CELL MODULE

engineered & designed in
GERMANY



BAUER guarantees a minimum performance value of 87.4% after 30 years for the **SUPERBLACK** glass-glass solar modules.

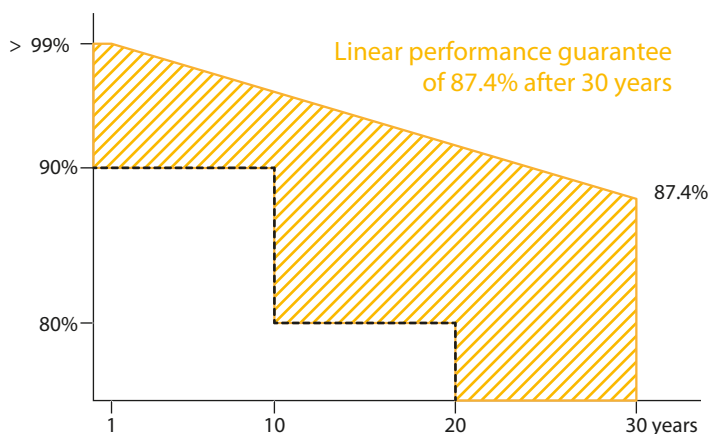
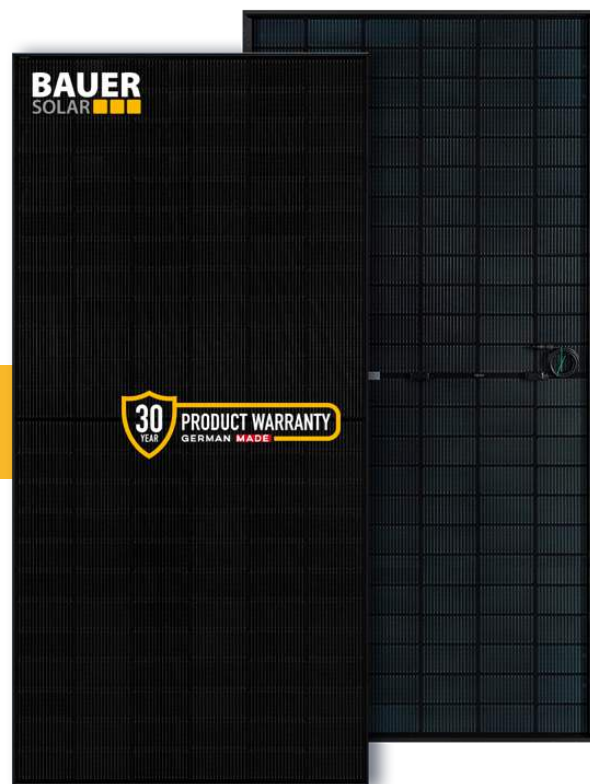

FIRE CLASS A

Maximum fire protection through double glazing according to the highest security requirements



CERTIFICATION

Constant in-house quality controls - certified several times over by accredited inspection bodies



GRADE "A" N-TYPE BIFACIAL HALF-CELLS

Up to 30% increase in yield through bifacial cells active on both sides and a transparent backside. Only GRADE "A" half-cells are used in the production of all BAUER solar modules and only the blackest are selected.



GERMAN GUARANTOR

If necessary, it is guaranteed that a German company takes over any claim settlements



WARRANTY & GUARANTEE

30 year product warranty and a linear performance guarantee over a period of 30 years



REINSURANCE COVERAGE

BAUER is re-insured with Munich RE for 15 years of the product warranty & 30 years of the performance guarantee

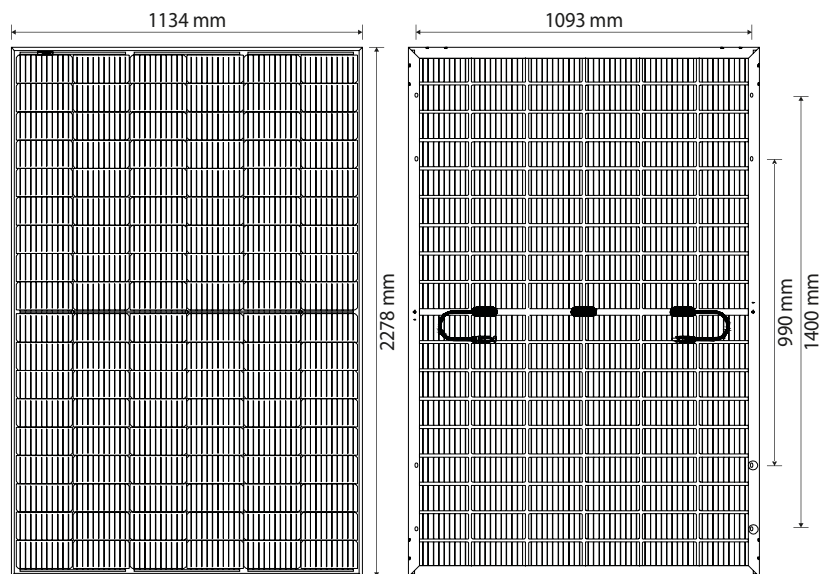

BAUER SOLARTECHNIK

SUPERBLACK

BS-144M10NHBB-GG 575 - 585 W

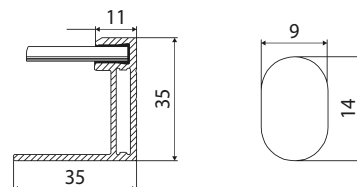

WARRANTIES¹

30 years product warranty

30 years performance guarantee

PHYSICAL SPECIFICATIONS

Module dimensions	2278 x 1134 x 35 mm
Weight	32.7 kg
Frame	Black anodized aluminum profile
Frontside	AR-coating Semi-toughened glass, 2 mm
Embedding material	EVA
Backside	Black-glazed & Semi-toughened glass, 2 mm
Solar cells	144 monocrystalline N-type bifacial half-cells
Bifaciality	80 % ± 10 %
Junction box(es)	IP68, 3 bypass diodes
Cable & connector	1x4 mm ² , 500 mm, MC4 compatible

OPERATING CONDITIONS

Operating temperature	-40 to 85°C
Static load	5400 Pa (snow/wind/ice)
Hail	Ø 25 mm at 23 m/s

CERTIFICATION

CSA, IEC 61215, IEC 61730, Fire Class A IEC 61730-2 (UL790)

PACKAGING

Modules per pallet	31
Pallets/Modules per container	20/620

ELECTRICAL CHARACTERISTICS²

		BS-575-144M10NHBB-GG	BS-580-144M10NHBB-GG	BS-585-144M10NHBB-GG
Maximum power	P _{max} (W)	575	580	585
Power output tolerance	P _{max} (%)	0 ~ +3	0 ~ +3	0 ~ +3
Open circuit voltage	V _{oc} (V)	51.26	51.44	51.65
Short circuit current	I _{sc} (A)	14.31	14.37	14.44
Voltage at maximum power	V _{mpp} (V)	42.53	42.70	42.92
Current at maximum power	I _{mp} (A)	13.54	13.60	13.65
Module efficiency	η _m (%)	22.26	22.45	22.65
Bifaciality performance increase*	10 % P _{mp} (W)	632.5 (+57.5)	638 (+58)	643.5 (+58.5)
	20 % P _{mp} (W)	690 (+115)	696 (+116)	702 (+117)
	30 % P _{mp} (W)	74.5 (+172.5)	754 (+174)	760.5 (+175.5)
Nominal operating cell temperature	NOCT (°C)	45 +/- 2		
Temperature coefficient of V _{oc}	T _k (V _{oc})	-0.26 %/°C		
Temperature coefficient of I _{sc}	T _k (I _{sc})	+0.046 %/°C		
Temperature coefficient of P _{mp}	T _k (P _{mp})	-0.30 %/°C		
Maximum system voltage DC (TÜV)	(V)	1500		
Maximum series fuse rating	(A)	30		

*depending on Albedo and irradiation conditions at installation site

¹Nominal value is specified in the written warranty conditions. A possible light-induced degradation in performance is not taken into account.

²Values under Standard Test Conditions (STC): air pressure 1.5 AM, irradiance 1000 W/m², cell temperature 25°C. STC measuring tolerance: ±3 % (P_{max}), ±10 % (V_{max}, I_{mp}, V_{oc}, I_{sc}). The beneficiary under the reinsurance policy is solely Bauer Solar GmbH. Please contact us to get information on how this insurance coverage benefits you as a customer.

Note: please read the safety instructions and installation manual before using this product.

Subject to change. © 2023 Bauer Solar GmbH. Effective: 04/04/23.